

USER MANUAL  
MULTI LANGUAGE



Item 71082 Version 1.0  
Visit [www.trustsmarthome.com](http://www.trustsmarthome.com)  
for the latest instructions

BUILD-IN MULTI DIMMER

1

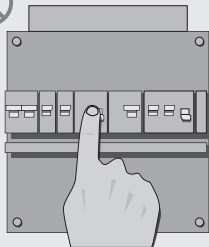

2

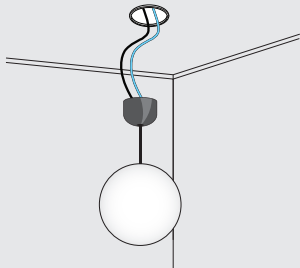

3

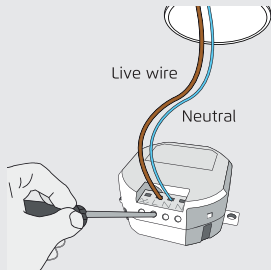

4

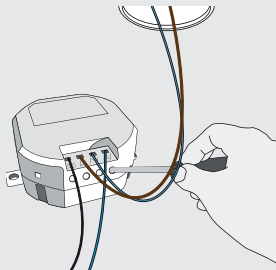

5

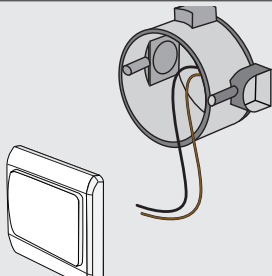

6

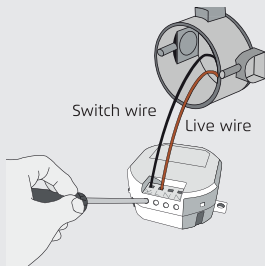

7

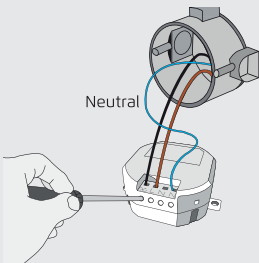

8

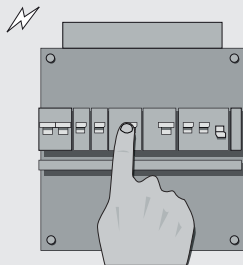

9

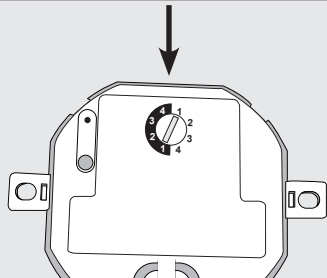

10

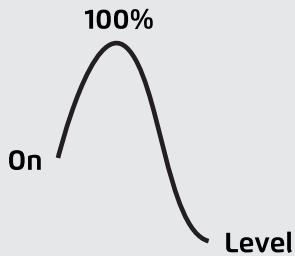

11

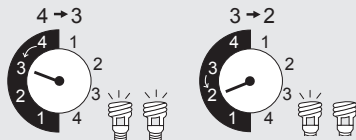

12

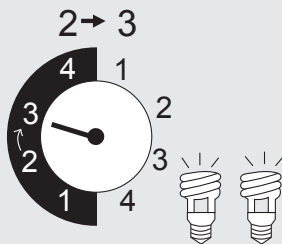

13

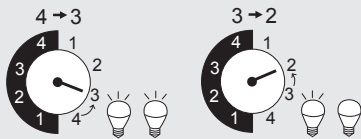

14

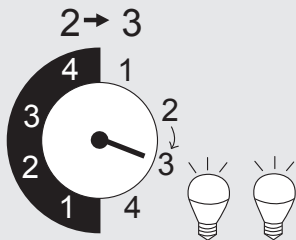

15

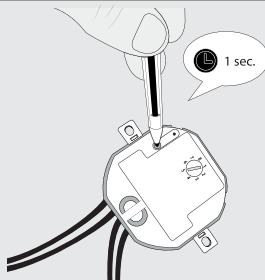

16

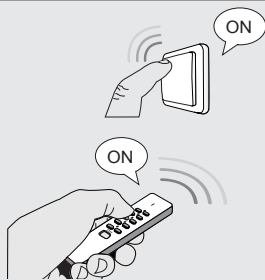

17

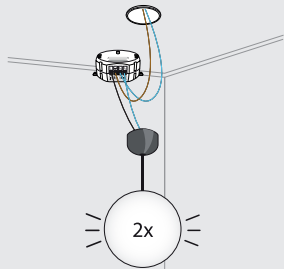

18

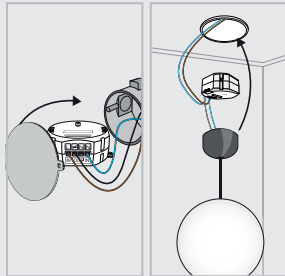

19

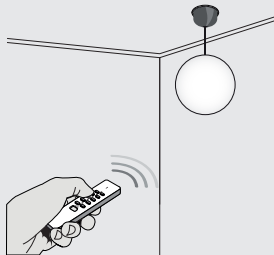

20

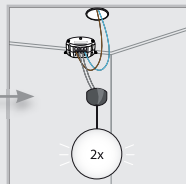
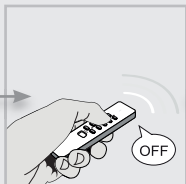
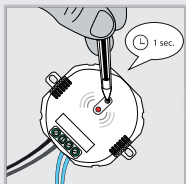

21

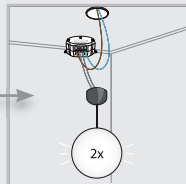
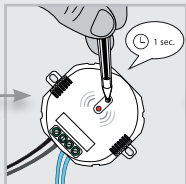
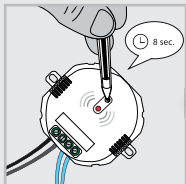

**1. Switch off the mains power (at the electricity meter)**

- Proceed to [2] for ceiling installation.
- Proceed to [5] for wall installation.

**2. Ceiling installation Unscrew the ceiling light**

Remove the existing light from the ceiling. Do not connect an electrical load that exceeds the maximum: 50 Watt (dimmmable LED and energy-saving bulbs) or 200 Watt (incandescent bulbs and (eco) halogen) respectively.

**3. Connect the phase wire and the neutral wire**

Connect the (black) phase wire to the [L] terminal and the (blue) neutral wire to the adjacent [N] terminal. Tighten up the terminal screws. If in doubt about the wire colours, consult a professional installer.

**4. Connecting the wires from the lamp**

Connect the two wires from the lamp to the two outside terminals, [⚡] and [N].

**5. Wall installation Unscrew the existing wall switch**

The ACM-100 is a replacement for an existing single wall switch. The receiver may not be used if the existing wall switch is used in a two-way wiring arrangement. Do not connect an electrical load that exceeds the maximum: 50 Watt (dimmmable LED and energy-saving bulbs) or 200 Watt (incandescent bulbs and (eco) halogen) respectively.

**6. Connect the phase wire to [L] and the switching wire to [⚡]**

1. Connect the (brown) phase wire to the [L] terminal.
2. Connect the (black) switching wire to the [⚡] terminal.

Tighten up the terminal screws. If in doubt about the wire colours, consult a professional installer.



### 7. Connecting a neutral wire to [N]

Connect a (blue) neutral wire to the right-hand [N] terminal [IN]. Tighten up the terminal screws. In most cases, a neutral wire will not be present in a single wall switch. If this is the case, a neutral wire must be laid to the switch.

### 8. Switching on the power

Switch the power back on before carrying on with the installation work. Avoid contact with exposed wiring. The LED indicator light on the receiver will light up continuously if a voltage is present.

### 9. Setting the dimming range

You must set the right dimming range first in order to achieve optimal dimming of the connected lighting. The ACM-100 is equipped with two setting dials marked from 1 to 4.

### 10. Important note

To assure correct dimming of dimmable ESL, this dimmer always switches to full brightness (100%) first. Immediately afterwards, the lights are set to the dim-level that you have chosen.

### 11. Setting the dimming range for dimmable ESL

Now slowly turn the dial backwards one step at a time. So from 4 to 3 first, then from 3 to 2, etc. Each time you change the position of the dial, the lighting will operate at full intensity first. Then it will dim automatically to the set value.

### 12. Setting the dimming range

As soon as you see that the dimming value is not acceptable (the lighting starts to flicker or goes out), turn the dial to the lowest position at which the dimming value operates correctly. That is position 3 in this example.

### 13. Setting the dimming range for other lights

Now slowly turn the dial backwards one step at a time. So from 4 to 3 first, then from 3 to 2, etc. Each time you change the position of the dial, the lighting will dim automatically to the set value.

**14. Setting the dimming range**

As soon as you see that the dimming value is not acceptable (the lighting starts to flicker or goes out), turn the dial to the lowest position at which the dimming value operates correctly. That is position 3 in this example.

**15. Activate learn-mode**

Press the learn-button on the receiver for 1 second. The learn-mode will be active for 15 seconds and the LED-indicator will blink slowly.

**16. Assign Trust SmartHome transmitter code**

While the learn-mode is active, send an ON-signal with any Trust SmartHome transmitter (except TMT-502 + PIR-2050) to assign the code to the receiver's memory.

**17. Code confirmation**

The receiver will switch on/off 2 times to confirm the code has been received. The receiver can store up to 6 different transmitter codes in its memory. The memory will be preserved when the receiver is moved to another location or in case of power failure.

**18. Mount the receiver in the box**

Mount the receiver in the wall or ceiling box (break off the mounting tabs if necessary) and cover it up with a blind cover or mount the light back onto the ceiling again.

**19. Manual operation and dimming with a Trust SmartHome transmitter**

1. Press ON once to switch the receiver on.
2. Press ON again to activate the dim-mode. The light will slowly dim up and down.
3. Press ON a third time to set the desired light intensity.
4. Press OFF to switch the receiver off. The receiver will return to the last light level when switched on again.

**20. Single code delete**

1. Press the learn-button for 1 second. The learn-mode will be active for 15 seconds and the LED-indicator will blink slowly.
2. While the learn-mode is active, send an OFF-signal of a specific Trust SmartHome transmitter to delete that code.
3. The receiver will switch on/off 2 times to confirm code deletion.

**21. Full memory delete**

1. Press and hold the learn-button on the receiver (approx. 7 sec.) until the LED-indicator starts blinking fast. The delete mode will be active for 15 seconds.
2. While the delete mode is active, press the learn-button again for 1 second.
3. The receiver will switch on/off 2 times to confirm memory deletion.

IMPORTANT INFORMATION  
MULTI LANGUAGE



Item 71082 Version 1.0  
Visit [www.trustsmarthome.com](http://www.trustsmarthome.com)  
for the latest instructions

BUILD-IN MULTI DIMMER

## EN ACM-100 BUILD-IN MULTI DIMMER

Read these simple instructions in order to avoid incorrect use and prevent dangerous situations. Incorrect installation voids the guarantee for this product.

### DESCRIPTION

You can use this invisible-mount wireless dimmer to dim the lights. The receiver can be neatly mounted in an existing flush-fit enclosure (wall/ceiling) or a splash-proof flush-fit enclosure (OWH-001) and can be operated via any Trust SmartHome transmitter (up to a maximum of six transmitters per dimmer).

### COMPATIBILITY

This receiver is compatible with all Trust SmartHome transmitters.

### FUNCTION

On/off + dim function in combination with Trust SmartHome transmitter. The connected lighting must be suitable for dimming.

### TECHNICAL DATA

- |                              |  |
|------------------------------|--|
| • Power supply               | 220-240 VAC 50 Hz  |
| • Maximum load               | 50 watt (dimmable LED and energy-saving bulbs) 200 watt (incandescent bulbs and (eco) halogen) |
| • RF frequency               | 433.92 MHz   |
| • RF reception range         | Up to 30 m indoors, up to 70 m outdoors (optimum conditions)                                   |
| • Memory addresses           | 6  |
| • Stand-by power consumption | < 1 watt   |

### RECOMMENDED BULBS (refer to [www.trustsmarthome.com](http://www.trustsmarthome.com) for more information)

- |  |  |
|--|--|
| <input checked="" type="checkbox"/> Incandescent bulbs                                 | <input checked="" type="checkbox"/> Dimmable energy-saving bulbs |
| <input checked="" type="checkbox"/> Eco halogen bulbs                                  | <input checked="" type="checkbox"/> Dimmable LED bulbs           |
| <input checked="" type="checkbox"/> 230V halogen bulbs                                 |  |
| <input checked="" type="checkbox"/> 12 V halogen bulbs with electronic transformer     |  |
| <input checked="" type="checkbox"/> 12 V halogen bulbs with ring core/coil transformer |  |

 Connect no more than 1 transformer for each receiver

### WIRELESS SIGNAL

- The 433.92 MHz radio signal penetrates walls, windows and doors.
- Indoor range: up to 30 m. Outdoor range: up to 70 m. (optimum conditions)
- The range depends on local conditions such as the presence of metals and other interference sources. For example, the metal particles in double glazing (HR glazing) reduce the wireless range of Trust SmartHome transmitters.
- Limitations may apply to the use of this device outside the EU. If this device is used outside the EU, you must check whether the device complies with local guidelines.

**INSTALLATION**

The wire colours may differ in practice. If in doubt, contact a professional installer. The receiver requires a continuous 230V mains supply in order to operate. When mounting in a flush-fit wall enclosure, check to ensure the presence of a (blue) neutral wire.

**MAXIMUM LOAD**

Do not connect bulbs or equipment that exceed the receiver's maximum load in order to prevent faults, short-circuit or fire.

**RISK OF ELECTRIC SHOCK**

Take great care when installing a receiver. A live voltage may be present at the receiver even if it is switched off.

**LIFE SUPPORT**

Never use Trust SmartHome products for "life support" systems or applications where equipment faults may lead to life-threatening situations.

**LEGAL INFORMATION**

CE: Trust declares this device complies with the Directives as listed in Section 2 of this document.  
WEEE: Dispose of the device at a recycling centre. More information: [www.trustsmarthome.com](http://www.trustsmarthome.com)  
Warranty information: [www.trustsmarthome.com/warranty](http://www.trustsmarthome.com/warranty)

**INTERFERENCE**

All wireless products may be adversely affected by interference. Place receivers at least 50 cm away from each other in order to prevent mutual interference.

**REPAIRS**

Do not attempt to repair or modify this product. If you doubt correct operation, return the product to the shop where you bought it.

**WATER AND MOISTURE**

This product is not water-resistant. Use a waterproof mounting enclosure for outdoor applications. This product may only be cleaned with a dry cloth.

**ENVIRONMENT/USAGE**

Do not expose the product to excessive heat or cold. Extreme temperatures have an adverse effect on the service life of electronics and batteries. Do not drop the product. Impacts may damage the internal electronics.

**CE Declaration of Conformity**

Trust International B.V. declares that this TRUST SMART Home-product:

Model:	ACM-100 BUILD-IN MULTI DIMMER
Item number:	71082
Intended use:	Indoor

is in compliance with the essential requirements and other relevant provisions of the following directives: EMC Directive, Low Voltage Directive and R&TTE Directive.

The product is compatible with the following norms/standards:

EN 60669-2-1:2004 +A1:2009 + A12:2010  
 EN 60669-2-2:2006  
 EN 60669-1:1999 + A1:2002 + A2:2008  
 EN 301 489-1 V1.9.2 (2011-09)  
 EN 301 489-3 V1.6.1 (2013-08)  
 EN 300 220-1 V2.4.1 (2012-05)  
 EN 300 220-2 V2.4.1 (2012-05)  
 EN 55015: 2006 +A1: 2007 +A2: 2009  
 EN 61000-3-2: 2006 +A1: 2009 +A2: 2009 Class A  
 EN 61000-3-3: 2008  
 EN 301 489-1 V1.9.2 (2011-09)

EN 301 489-3 V1.6.1 (2013-08)  
 EN 55022:2010+AC:2011  
 EN 61000-4-2: 2009  
 EN 61000-4-3: 2006 +A1: 2008 +A2: 2010  
 EN 61000-4-4: 2012  
 EN 61000-4-5: 2006  
 EN 61000-4-6: 2009  
 EN 61000-4-11: 2004

Authorized representative



H. Donker, Procurement Director  
 Dordrecht, 1-1-2015

**EUROTEC** People • Technology • Solutions  
HVAC • Refrigeration • Electrical • Measurement

**TRUST SMART Home**  
 LAAN VAN BARCELONA 600  
 3317DD DORDRECHT  
 NEDERLAND  
[www.trustsmarthome.com](http://www.trustsmarthome.com)