

USER MANUAL  
MULTI LANGUAGE

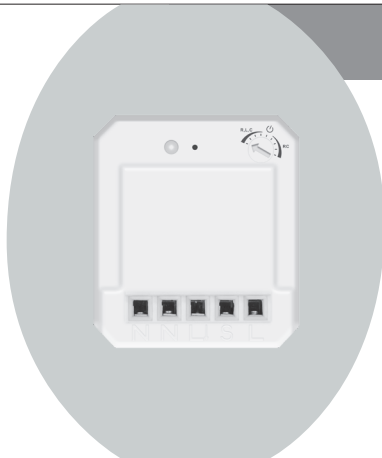

Item 71213 Version 1.0  
Visit [www.trust.com](http://www.trust.com)  
for the latest instructions

ACM-250-LD BUILD-IN DIMMER

## ACM-250-LD BUILD-IN DIMMER

1

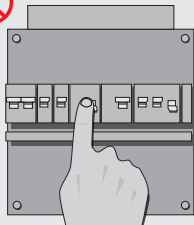

2

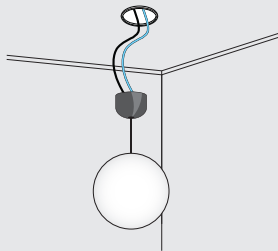

3



3A



3B

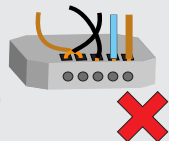
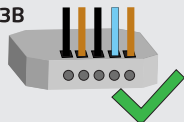

4

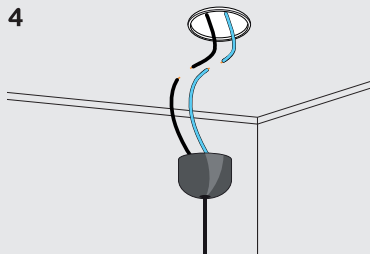

ACM-250-LD BUILD-IN DIMMER

5

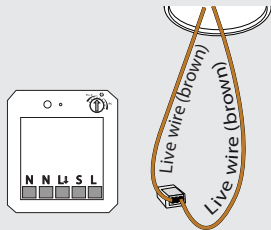

6a

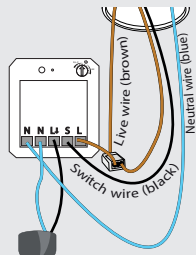

6b

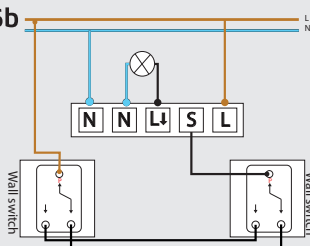

6c

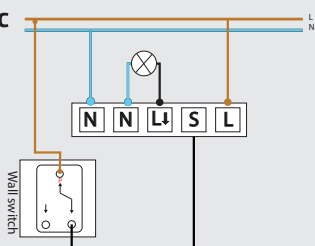

## ACM-250-LD BUILD-IN DIMMER

7

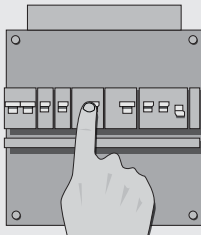

8a

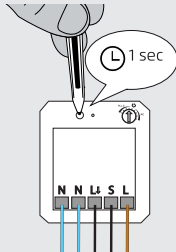

8b

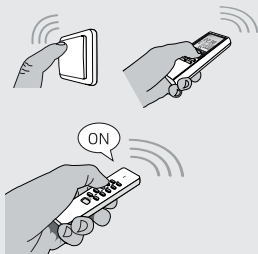

8c

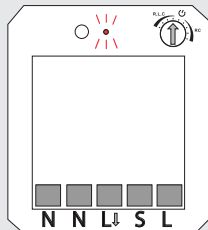

ACM-250-LD BUILD-IN DIMMER

9

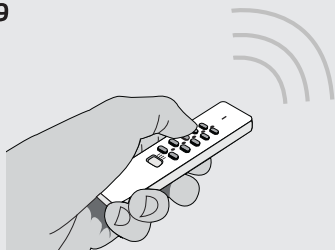

10



11

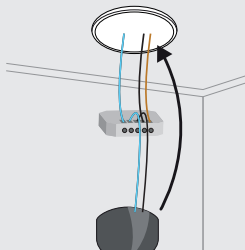

12



## ACM-250-LD BUILD-IN DIMMER

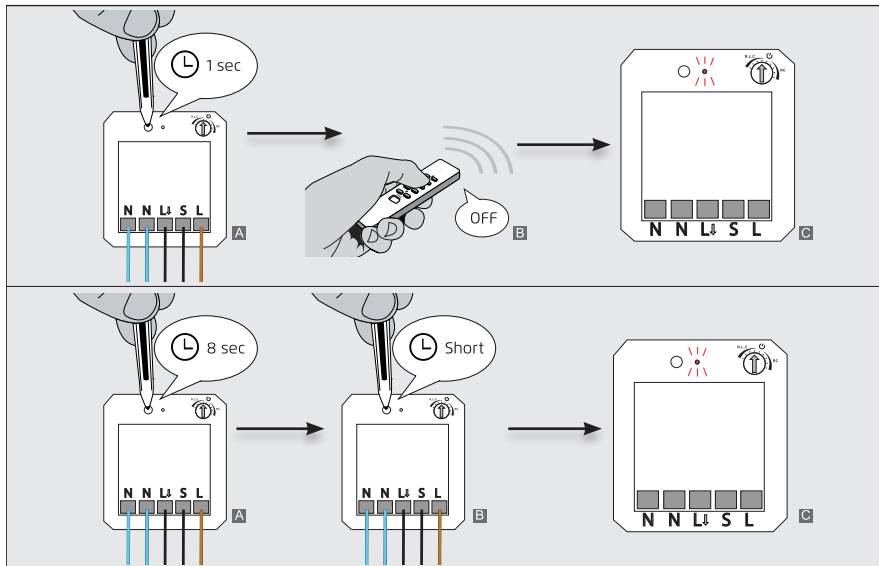

ACM-250-LD BUILD-IN DIMMER

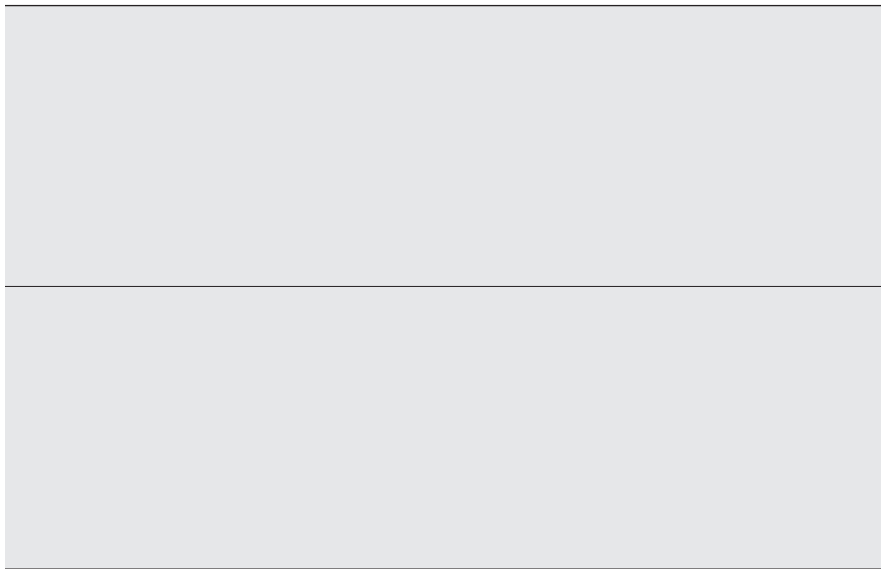

### 1. Disable mains power

Always turn OFF the mains power (In the fuse box) before you begin the installation or removal of this product. The ACM-250-LD can be used for either two wall switches connected with one lamp (stairwell/hotel circuit) or for one single wall switch connected to one lamp.

### 2. Loosen ceiling lights

Remove the existing lighting/equipment from the ceiling, leaving the wires connected to the lighting. Lighting/equipment may not exceed the maximum wattage. If there is no live wire (brown) present, it must be installed. Wire colors may vary per country. Consult an electrician if in doubt about wire colours.

### 3. Warning for stripping wires

3A. Make sure the wires are stripped for 5mm.

3B. When connecting the wires to the ACM-250-LD make sure the stripped wires are pressed firmly in the module, no exposed wires are visible and the wires cannot touch each other. This can cause a short circuit.

### 4. Disconnect the switch wire and neutral wire

To install the ACM-250-LD disconnect the switch wire (black) and neutral wire (blue) of the lamp (Disconnect from terminal block or cut the wires if necessary)

### 5. Connect the live wire to a terminal block

Connect the live wire (brown) from the ceiling box to a terminal block. Connect the other end of the live wire (brown) also back into the same terminal block.

### 6A. Connect the wires to the module

- Connect the neutral wire (blue) from the ceiling box to the outer [N] contact of the module
- Connect the switch wire (black) from the ceiling box to the [S] contact.
- Connect the neutral wire (blue) from the lamp to the middle [N] contact.
- Connect the switch wire (black) from the lamp to the [L↓] contact.
- Connect one new live wire (brown) from the live wire (brown) terminal block to the [L] contact.



- Tighten the terminal screws firmly.

**6B. This is the technical installation schematic of the ACM-250-LD with two wall-switches (hotel/stairwell circuit).**

**6C. This is the technical installation schematic of the ACM-250-LD with one wall-switch.**

## **7. Enable mains power**

Switch the mains power ON before proceeding with the installation.

 Make sure no stripped parts of wires are touched after this step. The LED indicator on the receiver will light up for a few seconds when voltage is applied.

## **8A. Activate pairing mode**

Press for about 1 second (with a pointed object) on the Connect button to activate the pairing mode. The pairing mode will be active for 12 seconds and the LED indicator on the receiver will flash slowly.

## **8B. Send an ON signal**

While the LED indicator flashes, press the ON button on a Trust Smart Home transmitter to pair the transmitter to the ACM-250-LD. (Or activate a Trust Smart Home sensor).

## **8C. Pairing confirmation**

The LED on the module will blink fast in order to confirm that the code is stored. The receiver can store up to 32 different transmitter codes in its memory. The memory is retained when the receiver is installed elsewhere or when there is a power failure.

## **9. Wireless control**

Send with the transmitter an ON signal to turn the light on wirelessly.

Send with the transmitter an OFF signal to turn the light off wirelessly.

With the AYCT-202, the lighting can be dimmed with the dimming buttons.

Consult the manual of the transmitter for more information.

The existing wall switches which are used to control the connected lighting can still be used.

## 10. Activate dim sequence

- Press the ON button on the transmitter to turn the receiver on.
- Press ON again to activate the dim sequence.
- Press ON a third time to lock the desired dim level

The dim sequence will stop and automatically lock the dim level at the highest or lowest point when no input is given with a transmitter. To activate the dim sequence with a 230V wall switch, switch it ON first. Then quickly turn the wall switch OFF and ON. To lock the desired dimming level, turn the wall switch OFF and ON again quickly.

## 11. Placing the receiver

 First check if the lighting dims without interference. If there is an interference in your lighting, first go to step 12 to select a different dimming mode.

Place the receiver in the ceiling box. Mount the lights back in place.

Make sure that you can always reach the receiver, for example, to reset it, or to register a new transmitter.

 Make sure no stripped parts of wires touch each other.

## 12. Dimming mode

If your lighting pulses or vibrates, you can choose a different dimming mode by turning the rotary switch clockwise until it stops interfering.

**RLC (Leading edge):** Dimmable incandescent-, halogen-, LED -lamps and lamps with a traditional (wound coil) dimmable transformer

**RC (Trailing edge):** Dimmable incandescent-, halogen-, LED -lamps and lamps with an electronic dimmable transformer

**ON-OFF:** Non-dimmable lamps / transformers

 Should your lighting still vibrate then check whether your lamp is dimmable or try another dimmable lamp.

### Deleting a single transmitter code

- A** Press for about 1 second on the Connect button. The pairing mode will be active for 12 seconds and the LED indicator on the receiver will flash slowly.
- B** Send while the pairing mode is active with the connected Trust Smart Home transmitter an OFF signal. If necessary, consult the instruction manual of the transmitter.
- C** The LED on the module will flash to confirm that the code has been removed.

Repeat this procedure to delete several transmitters from the receiver.

### Erase entire memory

- A** Press the Connect button for about 8 seconds until the LED indicator flashes quickly.
- B** When the LED indicator flashes rapidly, press the Connect button again shortly to confirm that you want to completely erase the memory.
- C** The LED on the module flashes to confirm that the memory has been erased.