

E10843



Clamp for tie-rod cylinder

ADAPTER TIE ROD CYLINDERS

Article to be discontinued

Alternative articles: MK5214

When selecting an alternative article and accessories please note that technical data may differ!

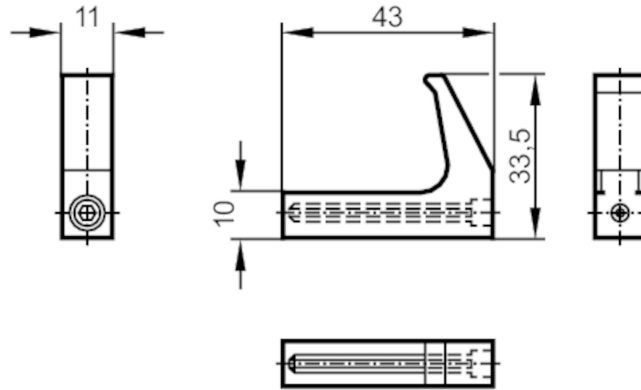

Application

Design

for magnetic-inductive sensor, tie rod cylinder

Mechanical data

Weight

[g]

38.3

Dimensions

[mm]

33.5 x 11 x 43

Material

diecast zinc PTFE coated

Remarks

Pack quantity

1 pcs.